

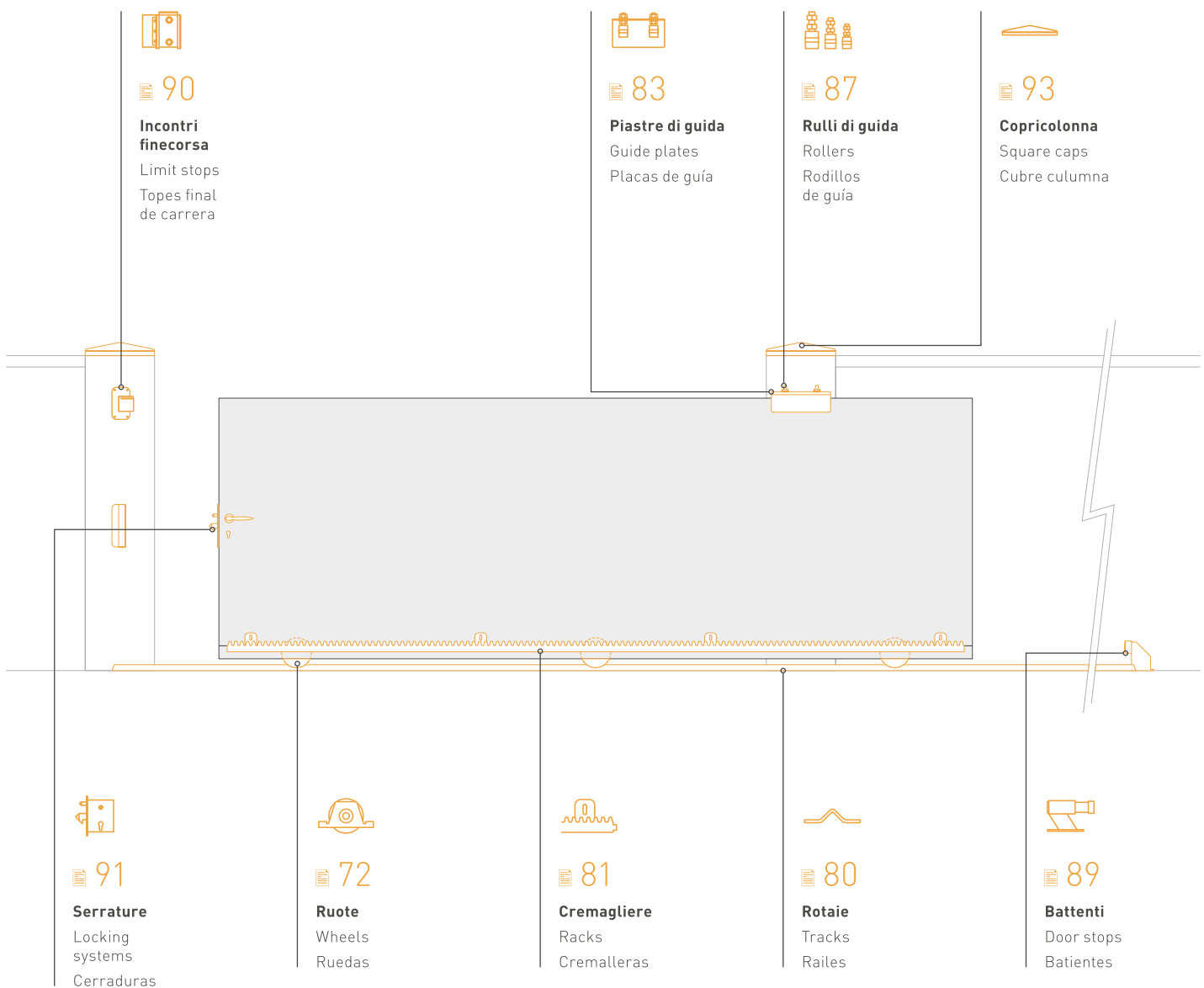

CANCELLI SCORREVOLI SU ROTAIA

SLIDING GATES ON TRACK

PUERTAS CORREDERAS SOBRE RAÍL





Durata cuscinetto

Bearing's lifetime
Duración del cojinete

Durata in anni
Lifetime/years
Duración en años

=

$$\frac{\text{Percorrenza (km)} \times 1000}{\text{Percorrenza giornaliera (m)}}$$

Distance (km)
Distancia (km)

Daily distance (m)
Distancia diaria (m)

$$365 \times \text{Percorrenza giornaliera (m)}$$

Diametro Diameter Diámetro	50 mm	60 mm	80 mm	90 mm	100 mm	120 mm	140 mm	160 mm	200 mm	250 mm	300 mm
Percorrenza Distance Distancia	120 km	150 km	220 km	250 km	280 km	345 km	400 km	450 km	580 km	750 km	900 km



Ruota zincata con bullone semplice, gola a V, 1 cuscinetto

Galvanized wheel with bolt, with V groove, 1 bearing
Rueda galvanizada con perno sencillo, canal en V, 1 rodamiento

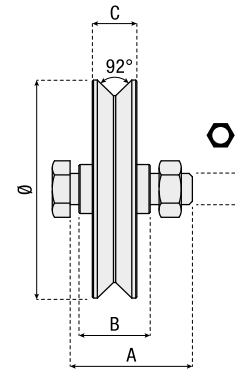

	∅ (mm)	kg	A (mm)	B (mm)	C (mm)	Ø	⊕
100.50	48	100	45	24	17	M10	10
100.60	58	200	50	26	20	M12	10
100.80	78	250	60	32	20	M14	6
100.90	88	250	60	32	20	M14	10
100.100	98	250	60	32	20	M14	4
100.120	118	250	60	32	20	M14	4
100.140	138	250	60	32	20	M14	4
100.160	158	250	60	32	20	M14	2
100.200	198	250	60	32	20	M14	2



Ruota zincata con bullone semplice, gola a V, 2 cuscinetti

Galvanized wheel with bolt, with V groove, 2 bearings
Rueda galvanizada con perno sencillo, canal en V, 2 rodamientos

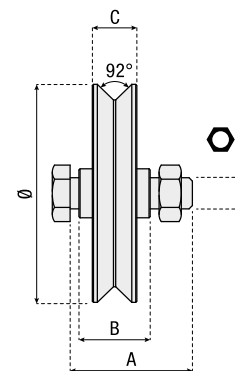

	∅ (mm)	kg	A (mm)	B (mm)	C (mm)	Ø	⊕
101.80	78	500	70	34	30	M14	4
101.90	88	500	70	34	30	M14	4
101.100	98	500	70	34	30	M14	4
101.120	118	500	70	34	30	M14	4
101.140	138	500	70	34	30	M14	4
101.160	158	500	70	34	30	M14	2
101.200	198	500	70	34	30	M14	2
101.250	248	800	80	48	38	M16	1



Ruota zincata con bullone semplice, gola piana, 1 cuscinetto

Galvanized wheel with bolt, with plane groove, 1 bearing

Rueda galvanizada con perno sencillo, canal plano, 1 rodamiento

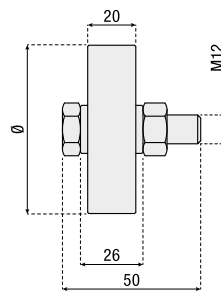

	Ø (mm)	(kg)	
100.60P	60	200	6
100.70P	70	200	6



Ruota zincata con bullone semplice, gola tonda, 1 cuscinetto

Galvanized wheel with bolt, with half-round groove, 1 bearing

Rueda galvanizada con perno sencillo, canal redondo, 1 rodamiento

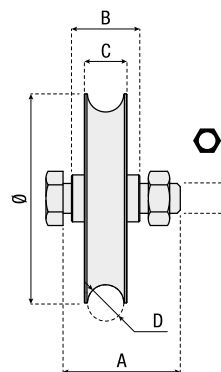

	Ø (mm)	(kg)	A (mm)	B (mm)	C (mm)	D (mm)	Ø	
102.60	58	200	50	26	20	16	M12	10
102.80	78	250	60	32	20	16	M14	6
102.90	88	250	60	32	20	16	M14	8
102.100	98	250	60	32	20	16	M14	4
102.120	118	250	60	32	20	16	M14	4
102.140	138	250	60	32	20	16	M14	4
102.160	158	250	60	32	20	16	M14	2
102.200	198	250	60	32	20	16	M14	2
103.80	78	250	60	32	24	20	M14	6
103.90	88	250	60	32	24	20	M14	8
103.100	98	250	60	32	24	20	M14	6
103.120	118	250	60	32	24	20	M14	4
103.140	138	250	60	32	24	20	M14	2



Ruota con staffa con gola quadra 27x16 mm

Wheel with bracket with square groove 27x16 mm

Rueda con abrazadera con canal cuadrado de 27x16 mm

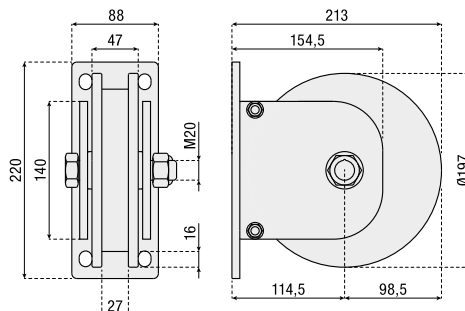

	(kg)	
104.27.200	2200	1



Ruota zincata con bullone semplice, gola tonda, 2 cuscinetti

Galvanized wheel with bolt, with half-round groove, 2 bearings

Rueda galvanizada con perno sencillo, canal redondo, 2 rodamientos

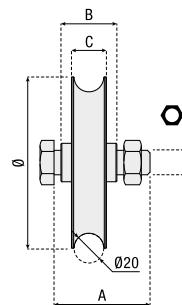

	Ø (mm)	kg	A (mm)	B (mm)	C (mm)	Hex	Bearings
104.80	78	500	70	34	30	M14	8
104.100	98	500	70	34	30	M14	6
104.120	118	500	70	34	30	M14	4
104.140	138	500	70	34	30	M14	4
104.160	158	500	70	34	30	M14	2
104.200	198	500	70	34	30	M14	2
104.250	248	800	80	48	38	M16	1



Ruota zincata con bullone semplice, gola quadra, 1 cuscinetto

Galvanized wheel with bolt, square groove, 1 bearing

Rueda galvanizada con perno sencillo, canal cuadrado, 1 rodamiento

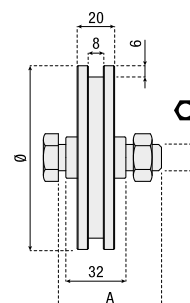

	Ø (mm)	kg	A (mm)	Hex	Bearings
105.60	58	250	50	M12	10
105.80	78	250	60	M14	6
105.90	88	250	60	M14	12
105.100	98	250	60	M14	4
105.120	118	250	60	M14	4
105.140	138	250	60	M14	4
105.160	158	250	60	M14	2
105.200	198	250	60	M14	2



Ruota zincata con bullone semplice, gola quadra, 2 cuscinetti

Galvanized wheel with bolt, square groove, 2 bearings

Rueda galvanizada con perno sencillo, canal cuadrado, 2 rodamientos

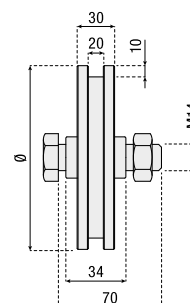

	Ø (mm)	kg	Bearings
106.100	98	500	4
106.120	118	500	4
106.140	138	500	4
106.160	158	500	2
106.200	198	500	2



Ruota zincata con supporto interno, gola a V, 1 cuscinetto

Galvanized wheel with internal support, with V groove, 1 bearing

Rueda galvanizada con soporte interno, canal en V, 1 rodamiento

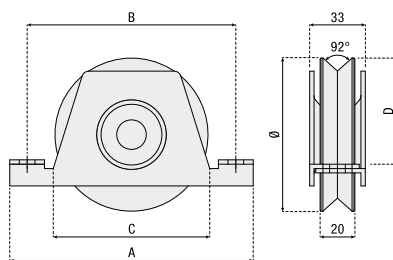

	Ø (mm)	▲ (kg)	A (mm)	B (mm)	C (mm)	D (mm)	📦
109.80	78	250	140	120	90	53	6
109.90	88	250	140	120	90	58	6
109.100	98	250	140	120	90	73	6
109.120	118	250	190	165	130	89	4
109.140	138	250	190	165	130	99	4



Ruota zincata con supporto interno, gola a V, 2 cuscinetti

Galvanized wheel with internal support, with V groove, 2 bearings

Rueda galvanizada con soporte interno, canal en V, 2 rodamientos

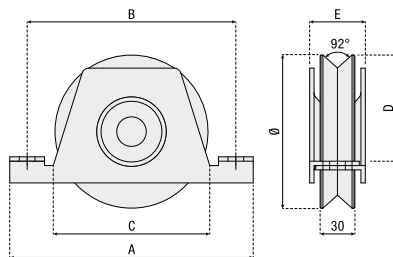

	Ø (mm)	▲ (kg)	A (mm)	B (mm)	C (mm)	D (mm)	E (mm)	📦
110.90	88	500	140	120	90	58	45	6
110.100	98	500	140	120	90	73	45	4
110.120	118	500	190	165	130	89	45	2
110.140	138	500	190	165	130	99	45	2
110.160	158	500	260	230	170	127	41	2
110.200	198	500	260	230	200	147	41	2



Ruota zincata con supporto interno, gola tonda, 1 cuscinetto

Galvanized wheels with internal support, with half-round groove, 1 bearing

Rueda galvanizada con soporte interno, canal redondo, 1 rodamiento

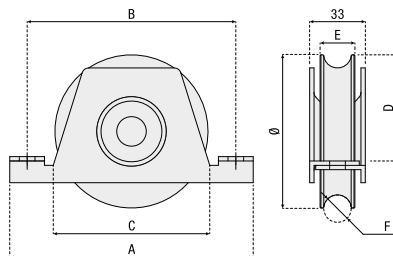

	Ø (mm)	▲ (kg)	A (mm)	B (mm)	C (mm)	D (mm)	E (mm)	F (mm)	📦
111.80	78	250	140	120	90	53	20	16	6
111.90	88	250	140	120	90	58	20	16	6
111.100	99	250	140	120	90	73	20	16	4
111.120	118	250	190	165	130	89	20	16	4
111.140	138	250	190	165	130	99	20	16	4
112.80	78	250	140	120	90	53	24	20	6
112.90	88	250	140	120	90	58	24	20	6
112.100	98	250	140	120	90	73	24	20	4
112.120	118	250	190	165	130	89	30	20	4
112.140	138	250	190	165	130	99	24	20	4



Ruota zincata con supporto interno, gola tonda, 2 cuscinetti

Galvanized wheels with internal support, with half-round groove, 2 bearings

Rueda galvanizada con soporte interno, canal redondo, 2 rodamientos

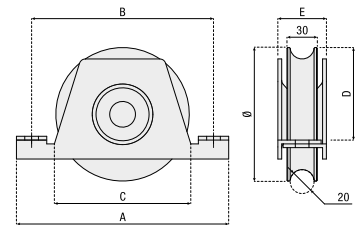

	∅ (mm)	kg	A (mm)	B (mm)	C (mm)	D (mm)	E (mm)	
113.90	88	500	140	120	90	58	45	6
113.100	98	500	140	120	90	73	45	4
113.120	118	500	190	165	130	89	45	2
113.140	138	500	190	165	130	99	45	2
113.160	158	500	260	230	170	127	41	2
113.200	198	500	260	230	200	147	41	2



Ruota con supporto esterno, gola a V, 1 cuscinetto

Wheel with external support, with V groove, 1 bearing

Rueda con soporte externo, canal en V, 1 rodamiento

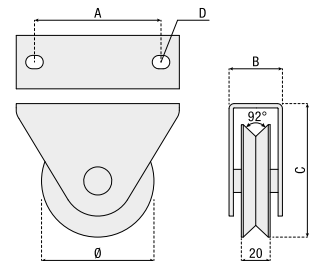

	∅ (mm)	kg	A (mm)	B (mm)	C (mm)	D (mm)	
125.60	58	200	63,5	26	64	6,5 x 8,5	6
125.80	78	250	90	37	96	8,5 x 12,5	6
125.100	98	250	90	37	106	8,5 x 12,5	4



Ruota con supporto esterno, gola piana, 1 cuscinetto

Wheel with external support, with plane groove, 1 bearing

Rueda con soporte externo, canal plano, 1 rodamiento

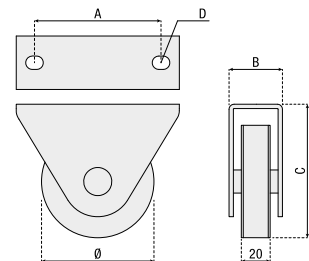

	∅ (mm)	kg	A (mm)	B (mm)	C (mm)	D (mm)	
125.60P	58	200	63,5	26	64	6,5 x 8,5	6
125.70P	70	200	90	37	92	8,5 x 12,5	4



Ruota con supporto esterno, gola tonda, 1 cuscinetto

Wheel with external support, with half-round groove, 1 bearing

Rueda con soporte externo, canal redondo, 1 rodamiento

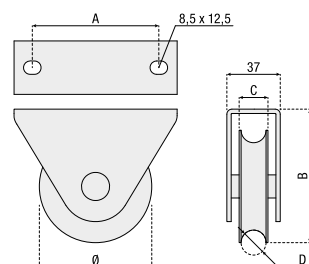

	∅ (mm)	kg	A (mm)	B (mm)	C (mm)	D (mm)	
126.80	78	250	90	96	20	16	6
126.100	98	250	90	106	20	16	6
127.80	78	250	140	96	24	20	6
127.100	98	250	190	106	24	20	6



Ruota con fiancate a saldare, gola a V, 1 cuscinetto

Wheel with side panel to be welded, with V groove, 1 bearing

Rueda con costados para soldar, canal en V, 1 rodamiento

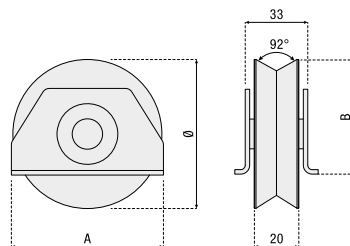

	Ø (mm)	kg	A (mm)	B (mm)	
129.80	78	250	100	66	6
129.90	88	250	100	71	6
129.100	98	250	100	76	6
129.120	118	250	120	96	2
129.140	138	250	120	106	2



Ruota con fiancate a saldare, gola a V, 2 cuscinetti

Wheel with side panel to be welded, with V groove, 2 bearings

Rueda con costados para soldar, canal en V, 2 rodamientos

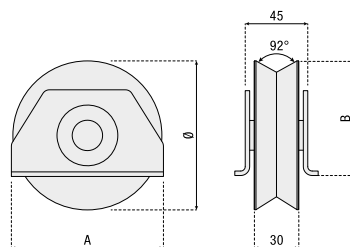

	Ø (mm)	kg	A (mm)	B (mm)	
128.90	88	500	100	71	6
128.100	98	500	100	76	6
128.120	118	500	120	96	2
128.140	138	500	120	106	2



Ruota con fiancate a saldare, gola tonda, 1 cuscinetto

Wheel with side panel to be welded, with half-round groove, 1 bearing

Rueda con costados para soldar, canal redondo, 1 rodamiento

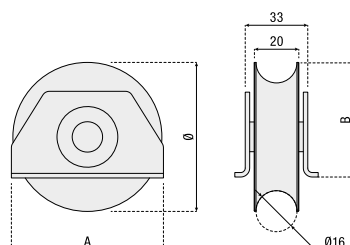

	Ø (mm)	kg	A (mm)	B (mm)	
130.80	78	250	100	66	6
130.90	88	250	100	71	6
130.100	98	250	100	76	2
130.120	118	250	120	96	2
130.140	138	250	120	106	2



Ruota con fiancate a saldare, gola tonda, 2 cuscinetti

Wheel with side panel to be welded, with half-round groove, 2 bearings

Rueda con costados para soldar, canal redondo, 2 rodamientos

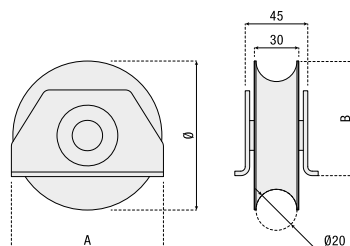

	Ø (mm)	kg	A (mm)	B (mm)	
131.90	88	500	100	71	4
131.100	98	500	100	76	6
131.120	118	500	120	96	2
131.140	138	500	120	106	2



Ruota zincata per basculanti, gola tonda, 1 cuscinetto

Galvanized overhead gate wheel, with half-round groove, 1 bearing

Rueda galvanizada para puertas basculantes, canal redondo, 1 rodamiento

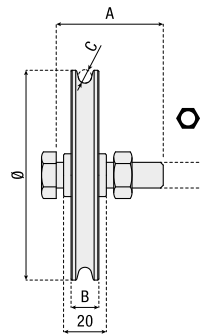

	Ø (mm)	kg	A (mm)	B (mm)	C (mm)	Ø	⊠
132.60	58	100	40	13	6	M10	30
132.80	78	200	50	13	6	M12	20
132.100	98	200	50	13	6	M12	10
133.60	58	200	40	15	8	M10	30
133.80	78	200	50	15	8	M12	20
133.100	98	200	50	15	8	M12	10
133.120	118	200	50	15	8	M12	8



Ruota zincata, con gola a V, 2 cuscinetti

Galvanized wheel, with V groove, 2 bearings

Rueda galvanizada, con canal en V, 2 rodamientos

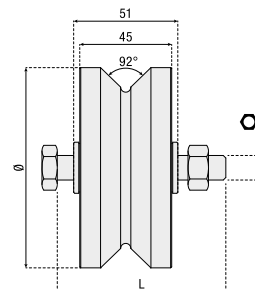

	Ø (mm)	kg	L (mm)	Ø	⊠
135.100	98	1000	3 1/4"	UNC 1/2"	1
135.148	148	1200	3 1/4"	UNC 5/8"	1



Ruota zincata gialla, con gola a V, 2 cuscinetti

Yellow galvanized wheel, with V groove, 2 bearings

Rueda galvanizada amarilla, canal en V, 2 rodamientos

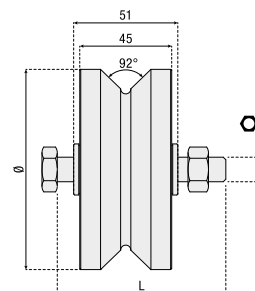

	Ø (mm)	kg	L (mm)	Ø	⊠
135.100G	98	1000	3 1/4"	UNC 1/2"	1
135.148G	148	1200	3 1/4"	UNC 1/2"	1



Box di protezione per ruota zincata

Protection box for galvanized wheel

Caja de protección para ruota galvanizada

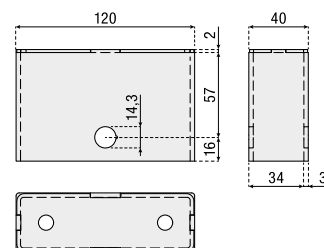

179.BOX.80

36



Ruota doppia con gola tonda, bilanciere e piastre a saldare

Double wheel with round groove, balancer and plates to be welded

Rueda doble con canal redondo, biela y placas para soldar

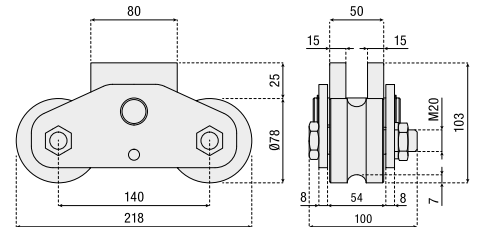

	(kg)	
155.80.A	1500	1



Ruota doppia con gola tonda, bilanciere e piastra forata di fissaggio

Double wheel with half-round groove, balancer and fixing plate with holes

Rueda doble con canal redondo, biela y placa perforada de fijación

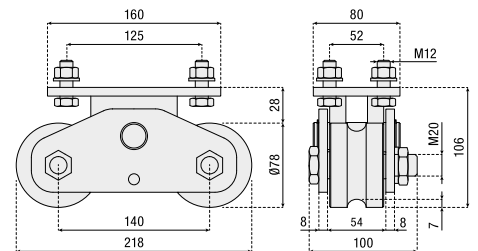

	(kg)	
155.80.B	1500	1



Rotaia a cementare per cancelli e portoni

Track to be cemented for gates and doors

Raíl a cementar para portones y puertas

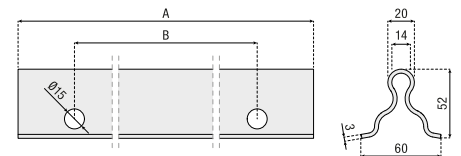

	A (mm)	B (mm)	
180.3	3000	6x470	1
180.6	6000	12x470	1



Rotaia a cementare per cancelli e portoni

Track to be cemented for gates and doors

Raíl a cementar para portones y puertas

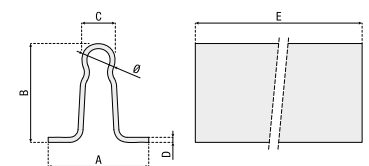

	A (mm)	B (mm)	C (mm)	D (mm)	E (mm)	Ø (mm)	
181.3	50	50	16	2,5	3000	10	1
181.6	50	50	16	2,5	6000	10	1
182.3	60	59	20	3	3000	14	1
182.6	60	59	20	3	6000	14	1



Spina di giunzione per rotaie a cementare

Joint pin for tracks to be cemented

Clavija de unión para raíles para cementar

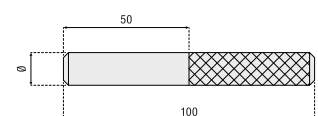

	Ø (mm)	
183.1	10	10
183.2	13	10



Rotaia a fissare per cancelli e portoni, con gola tonda

Track to be fixed for gates and doors, with half-round groove

Raíl para fijar para portones y puertas, con canal redondo

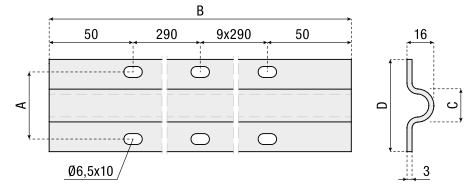

	A (mm)	B (mm)	C (mm)	D (mm)	
186.3	38	3000	16	53	1
186.6	38	6000	16	53	1
187.3	40	3000	20	55	1
187.6	40	6000	20	55	1



Rotaia INOX a fissare per cancelli e portoni, con gola tonda

Stainless steel track to be fixed for gates and doors, with half-round groove

Raíl INOX para fijar para portones y puertas, con canal redondo

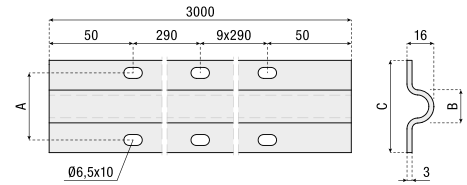

	A (mm)	B (mm)	C (mm)	
2186.3	38	16	53	1
2187.3	40	20	55	1



Rotaia a fissare per cancelli e portoni, con gola a V

Track to be fixed for gates and doors, with V groove

Raíl para fijar para portones y puertas, con canal en V

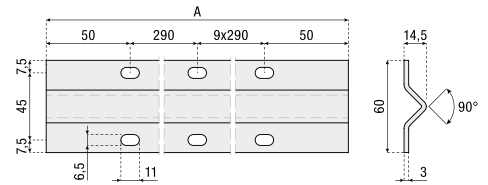

	A (mm)	
190.3	3000	1
190.6	6000	1



Cremagliera M4, con pioli a saldare

Rack M4, with studs to be welded

Cremallera M4, con distanciatori para soldar

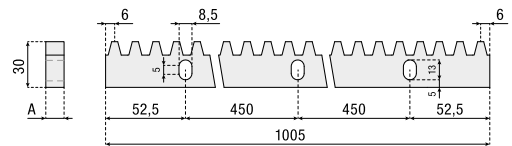

	A (mm)		
191.1	30x12 mm	12	1
193.1	30x8 mm	8	1



Cremagliera M4, con pioli a saldare

Rack M4, with studs to be welded

Cremallera M4, con distanciatori para soldar

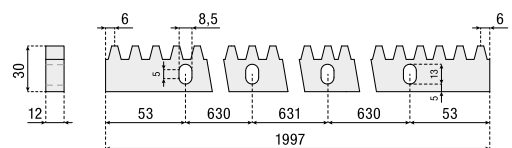

	A (mm)	
191.2	30x12 mm	1



Cremaġliera M4, con pioli a fissare

Rack M4, with studs to be fixed

Cremaġliera M4, con distanziadores para fijar

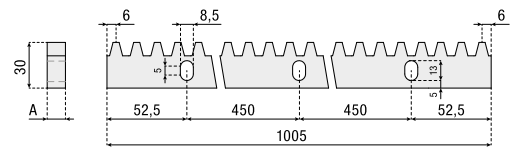

		A (mm)		
192.1	30x12 mm	12	1	
194.1	30x8 mm	8	1	



Cremaġliera M4, con pioli a fissare

Rack M4, with studs to be fixed

Cremaġliera M4, con distanziadores para fijar

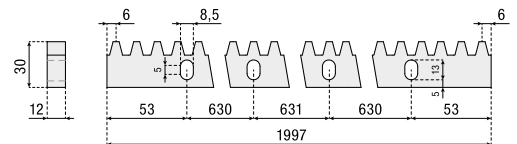

		A (mm)		
192.2	30x12 mm	12	1	



Piolino a saldare

Stud to be welded
Distanciador para soldar

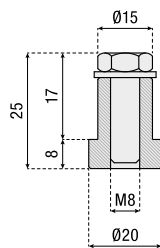

SC00041	30
---------	----



Piolino a fissare

Stud to be fixed
Distanciador para fijar

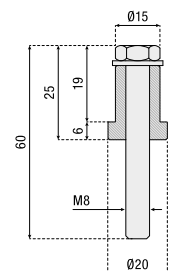

SC00051	30
---------	----

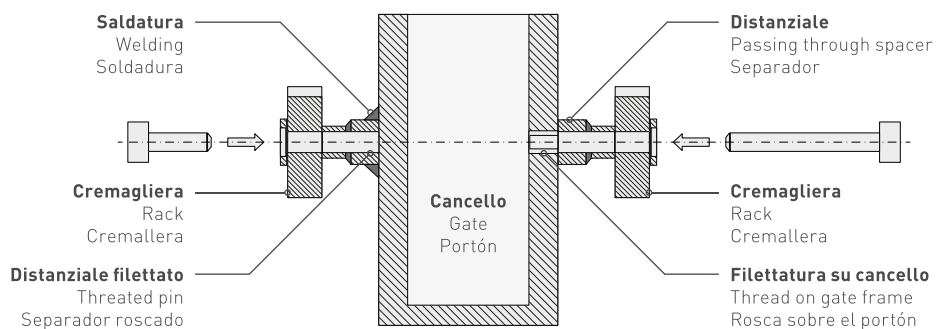

Cremaġliera M4

Rack M4
Cremaġliera M4

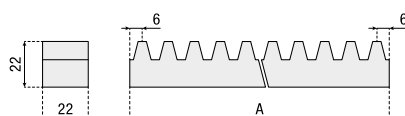

		A		
195.1	22x22 mm	1005	1	
195.2	22x22 mm	1997	1	



Cremaġliera M4, con viti M6x25 DIN912

Rack M4, with M6x25 DIN912 screws
Cremaġliera M4, con tornillos M6x25 DIN912

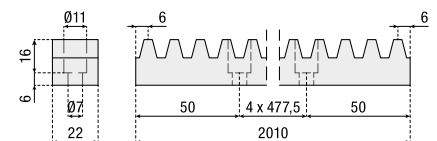

195.2F	22x22 mm	1
--------	----------	---



Cremagliera M6

Rack M6
Cremallera M6

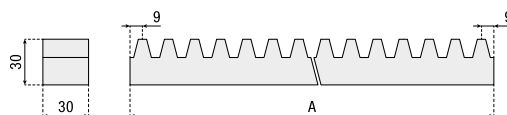

		A	
196.1	30x30 mm	998	1
196.2	30x30 mm	1997	1



Cremagliera in nylon con anima in acciaio

Nylon rack with steel core
Cremallera de nylon con núcleo de acero

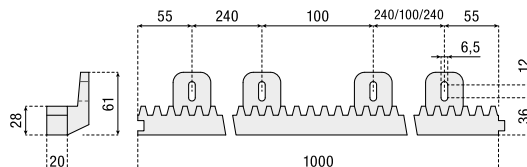

197.1	28x20 mm	1	



Staffa per cremagliera

Bracket for rack
Abrazadera para cremallera

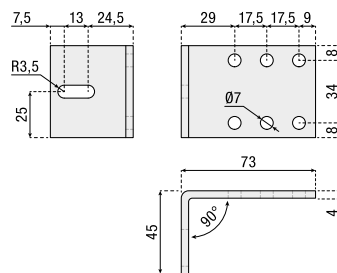

SC10301		10	



Piastra di guida a saldare con asola lunga per colonne in ferro, 2 rulli

Guide plate to be welded with long slot suitable for iron posts, 2 rollers

Placa de guía para soldar con agujero largo para columnas de hierro, 2 rodillos

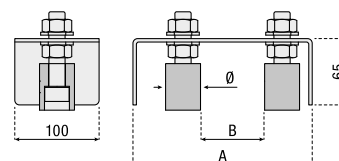

	Ø (mm)	A (mm)	B (mm)	
203.1	30	180	30-100	2
203.2	42	190	40-80	2



Piastra di guida a saldare con asola lunga per colonne in ferro, 4 rulli

Guide plate to be welded with long slot suitable for iron posts, 4 rollers

Placa de guía para soldar con agujero largo para columnas de hierro, 4 rodillos

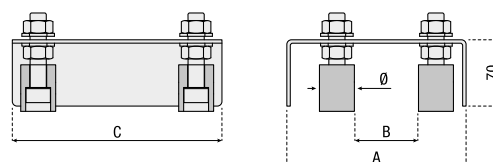

	Ø (mm)	A (mm)	B (mm)	C (mm)	
203.3	30	180	30-100	200	2
203.4	42	190	40-80	250	2



Piastra di guida a fissare con asola lunga, 4 rulli

Guide plate to be fixed with long slot, 4 rollers

Placa de guía para fijar con agujero largo, 4 rodillos

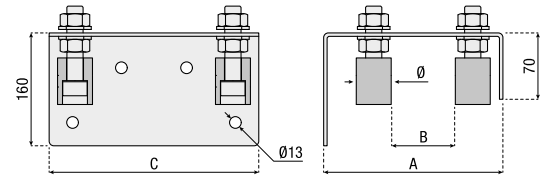

	Ø (mm)	A (mm)	B (mm)	C (mm)	
204.1	30	180	30-100	200	2
204.2	42	190	40-80	250	2



Piastra di guida regolabile a fissare, 4 rulli

Adjustable guide plate to be fixed, 4 rollers

Placa de guía regulable para fijar, 4 rodillos

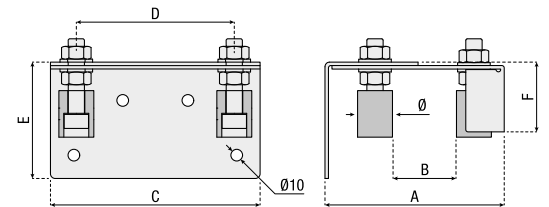

	Ø (mm)	A (mm)	B (mm)	C (mm)	D (mm)	E (mm)	F (mm)	
208.1	30	215-225	40-80	180	136	100	60	2
208.2	40	154-198	80-120	280	228	160	77	1



Piastra di guida regolabile a fissare

Adjustable guide plate to be fixed

Placa de guía regulable para fijar

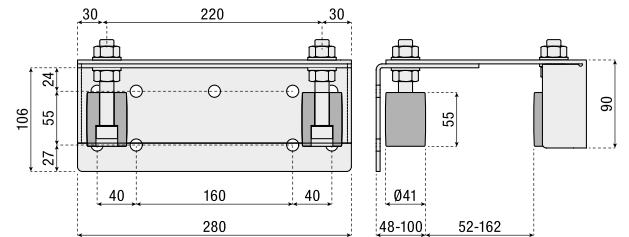

208.22	1
---------------	---



Flangia per 208.22, per colonna tonda

Flange for 208.22, for round post

Brida para 208.22, para columna redonda

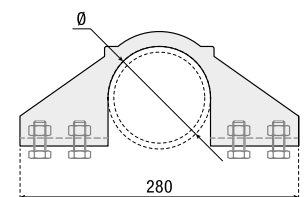

	Ø (mm)	
AU11051	89	2
AU11221	102	2
AU11271	114	2



Flangia per 208.22, per colonna quadrata

Flange for 208.22, for square post

Brida para 208.22, para columna cuadrada

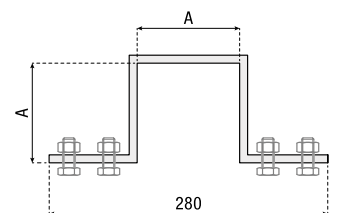

	A (mm)	
AU11231	89	2
AU11041	102	2



Piastra di guida regolabile a fissare

Adjustable guide plate to be fixed
Placa de guía regulable para fijar

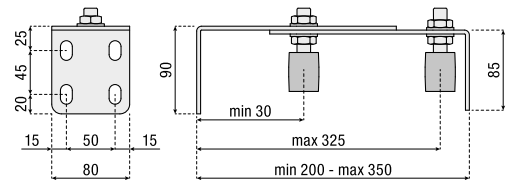

208.31 2



Piastra di guida regolabile a fissare

Adjustable guide plate to be fixed
Placa de guía regulable para fijar

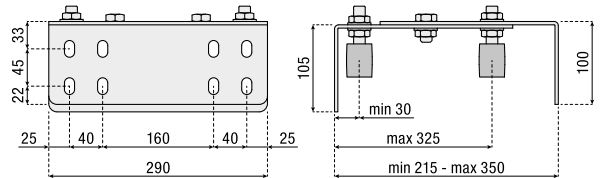

208.32 2



Protezione antinfortunistica per rulli in nylon

Accident-prevention guard for nylon rollers
Seguridad en la protección de los rodillos de nylon

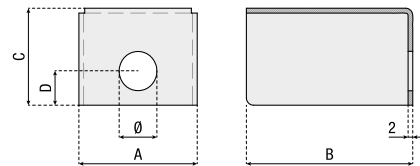

	A (mm)	B (mm)	C (mm)	Ø (mm)	D (mm)	
209.02	40,5	56	32	14,1	11	20
209.03	50,5	71	39,8	16,1	14	12



Angolare di guida regolabile, 2 rulli

Adjustable corner guide, 2 rollers
Angular de guía regulable, 2 rodillos

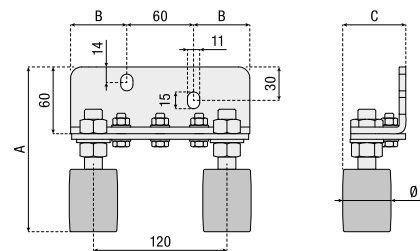

	Ø (mm)	A (mm)	B (mm)	C (mm)	
211.2B	31	125	50	min 49,5 - max 75	2
211.3B	40	148	50,5	min 55 - max 85	2



Staffa di guida regolabile a fissare, 2 rulli

Adjustable guide bracket to be fixed, 2 rollers
Abrazadera de guía regulable para fijar, 2 rodillos

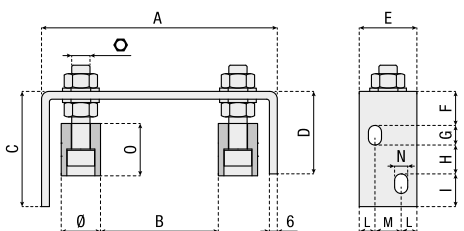

	Ø (mm)	A (mm)	B (mm)	C (mm)	D (mm)	E (mm)	F (mm)	G (mm)	H (mm)	I (mm)	L (mm)	M (mm)	N (mm)	O (mm)	Ø	
212.0	30	180	92	88	63	44	26	15	22	25	12	20	9	40	M14	6
212.3	40	200	90	100	65	50	25	16	39	20	15	22,5	11	56	M16	4



Staffa di guida a fissare, 2 rulli

Guide bracket to be fixed, 2 rollers

Abrazadera de guía para fijar, 2 rodillos

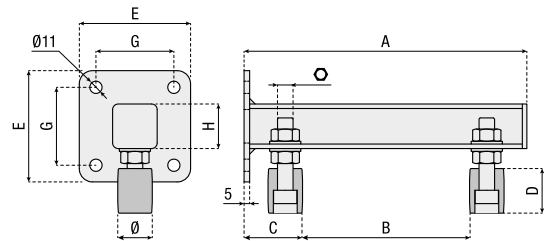

	Ø (mm)	A (mm)	B (mm)	C (mm)	D (mm)	E (mm)	F (mm)	G (mm)	H (mm)	Ø	🔩
213.2B	30	250	160	53	40	100	100	70	40	M14	2
213.3B	40	300	188	58	56	120	120	90	50	M16	2



Angolare di guida regolabile, 1 rullo

Adjustable corner guide, 1 roller

Angular de guía regulable, 1 rodillo

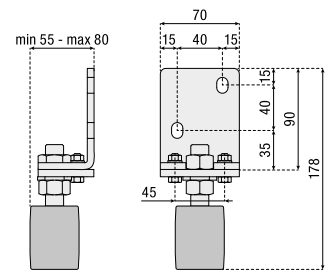

214.3B	2
---------------	---



Piastra di guida per colonna tonda, 2 rulli

Guide plate for round post, 2 rollers

Placa de guía para columna redonda, 2 rodillos

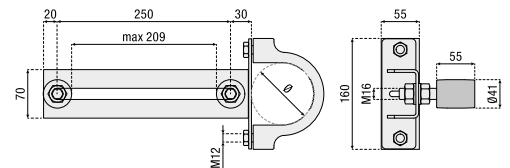

	Ø (mm)	🔩
215.32.89	89	2
215.32.102	102	2



Piastra di guida per colonna tonda, 4 rulli

Guide plate for round post, 4 rollers

Placa de guía para columna redonda, 4 rodillos

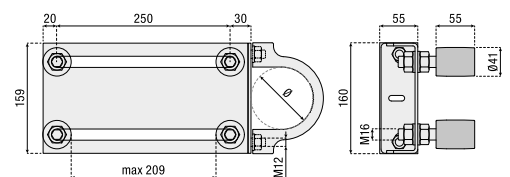

	Ø (mm)	🔩
215.34.89	89	2
215.34.102	102	2



Piastra di guida per colonna quadrata, 2 rulli

Guide plate for square post, 2 rollers

Placa de guía para columna cuadrada, 2 rodillos

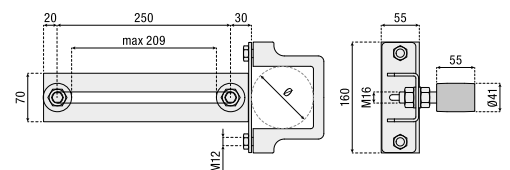

	Ø (mm)	🔩
215.32.89Q	89	2
215.32.102Q	102	2



Piastra di guida per colonna quadrata, 4 rulli

Guide plate for square post, 4 rollers

Placa de guía para columna cuadrada, 4 rodillos

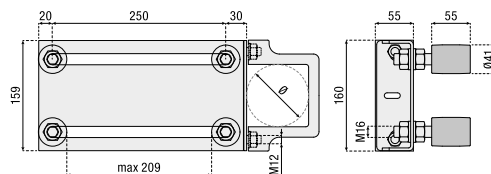

	Ø (mm)	
215.34.89Q	89	2
215.34.102Q	102	2



Rullo di guida in nylon bianco, con perno

White nylon guide roller, with pin

Rodillo de guía de nylon blanco, con perno

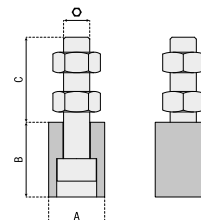

	A (mm)	B (mm)	C (mm)	Ø	
220.1	25	40	42	M12	20
220.2	30	40	45	M14	16
220.3	40	56	52	M16	12



Rullo di guida in nylon bianco, con rondella distanziatrice

White nylon guide roller, with spacer washer

Rodillo de guía de nylon blanco, con arandela separadora

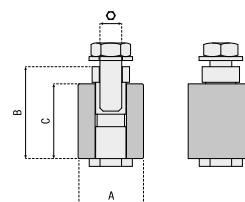

	A (mm)	B (mm)	C (mm)	Ø	
221.1	35	36	30	M10	10
221.2	42	60	48	M14	12
221.3	52	64	48	M16	12



Rullo di guida in nylon nero, con perno

Black nylon guide roller, with pin

Rodillo de guía de nylon negro, con perno

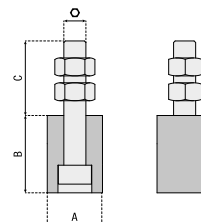

	A (mm)	B (mm)	C (mm)	Ø	
222.1	25	40	42	M12	20
222.2	30	40	45	M14	16
222.3	40	56	52	M16	12



Rullo di guida in nylon nero, con rondella distanziatrice

Black nylon guide roller, with spacer washer

Rodillo de guía de nylon negro, con arandela separadora

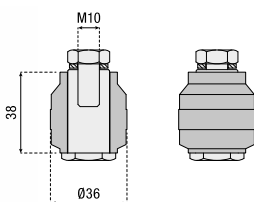

223.1 16



Rullo di guida in nylon nero, con rondella distanziatrice

Black nylon guide roller, with spacer washer

Rodillo de guía de nylon negro, con arandela separadora

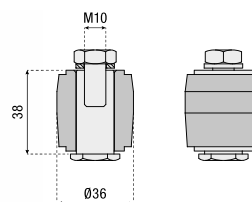

223.2 16



Rullo di guida in gomma NBR SH80

Rubber guide roller NBR SH80

Rodillo de guía de goma NBR SH80

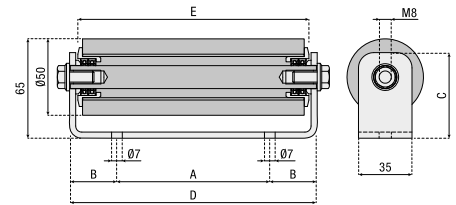

	A (mm)	B (mm)	C (mm)	D (mm)	E (mm)	
225.03	50	18,5	58	87	70	8
225.06	100	31	56	162	145	4
225.12	200	56	56	312	295	8



Rullo di guida in nylon bianco

White nylon guide roller

Rodillo de guía de nylon blanco

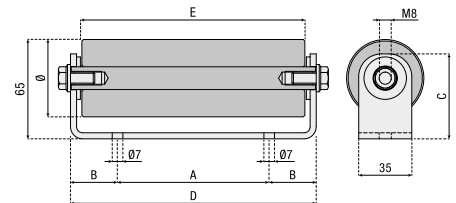

	Ø (mm)	A (mm)	B (mm)	C (mm)	D (mm)	E (mm)	
226.03	51	50	18,5	56	87	72	8
226.06	51	100	31	56	162	147	4
226.12	50	200	40	58	312	300	8



Rullo di guida in nylon bianco con piastra

White nylon guide roller with plate

Rodillo de guía de nylon blanco con placa

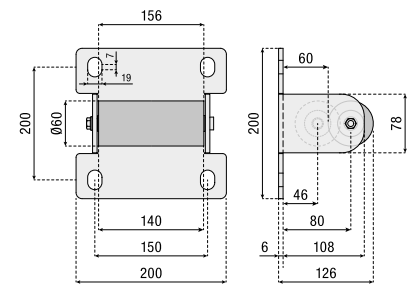

227.80 1



Rullo di guida in nylon bianco

White nylon guide roller

Rodillo de guía de nylon blanco

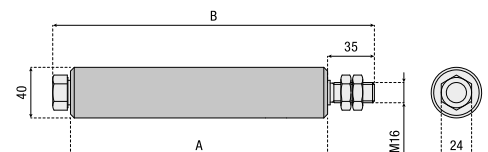

	A (mm)	B (mm)	
230.1	147	198	8
230.2	247	298	10



Rullo di guida in nylon bianco con piastra

White nylon guide roller with plate

Rodillo de guía de nylon blanco con placa

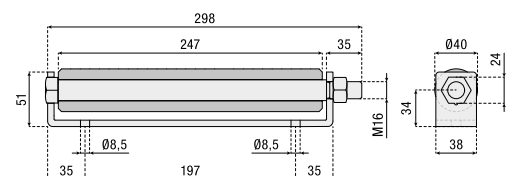

231.0 10



Battente finecorsa a saldare

Door stop to be welded
Tope final de carrera para soldar

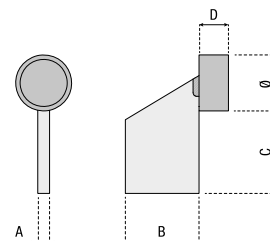

	A (mm)	B (mm)	C (mm)	D (mm)	Ø (mm)	
241.1	8	50	55	20	38	20
241.2	10	70	75	25	48	8



Battente finecorsa con piastra di fissaggio

Door stop with fixing plate
Tope final de carrera con placa de fijación

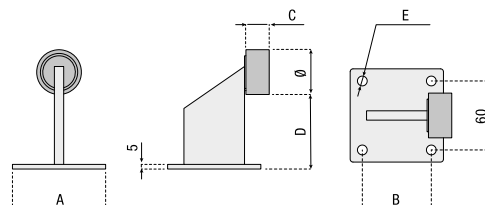

	Ø (mm)	A (mm)	B (mm)	C (mm)	D (mm)	E (mm)	
242.1	38	85	60	20	60	8,5	8
242.2	48	100	60	25	80	10,5	4



Battente finecorsa con piastra di fissaggio sagomata

Door stop with shaped fixing plate
Tope final de carrera con placa de fijación perfilada

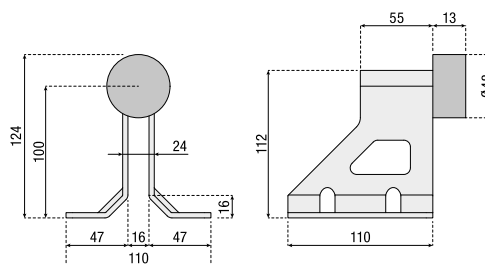

243.2		4
--------------	--	---



Battente finecorsa con tampone in gomma regolabile

Door stop with adjustable rubber pad
Tope final de carrera con tapón de goma ajustable

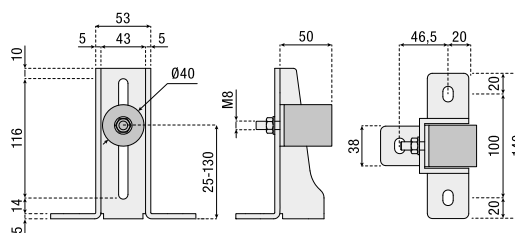

244.4		2
--------------	--	---



Battente finecorsa ammortizzato con molla, a saldare

Shock absorber with spring, to be welded
Tope final de carrera amortiguado con muelle, para soldar

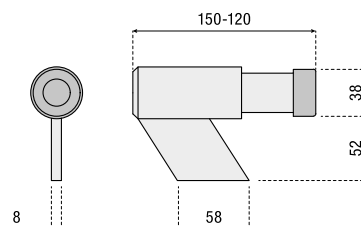

245.1		6
--------------	--	---



**Battente finecorsa
ammortizzato con
molla e piastra di
fissaggio**

Shock absorber
with spring and
fixing plate

Tope final de carrera
amortiguado
con muelle y placa
de fijación

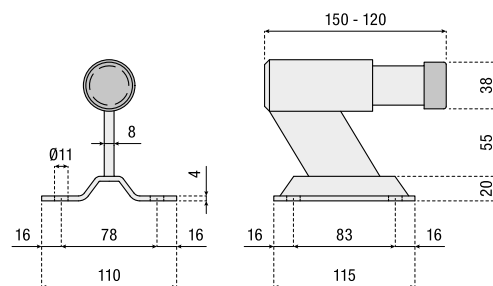

245.3

4



**Battente finecorsa
a fissare**

Door stop to be fixed

Tope final de carrera
para fijar

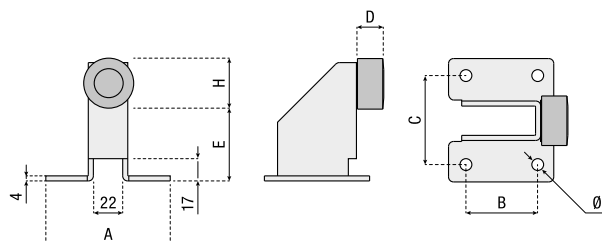

	A (mm)	B (mm)	C (mm)	D (mm)	E (mm)	F (mm)	Ø (mm)	
247.1	94	55	68	20	55	38	9	6
247.2	107	55	78	26	75	43	11	4



**Incontro
di sicurezza
a saldare**

Safety limit stop
to be welded

Placa de seguridad
para soldar

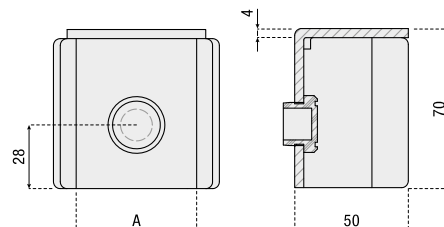

	A (mm)	
250.1	43	6
250.2	53	6
250.3	63	4
250.4	83	4



**Incontro
regolabile**

Adjustable
limit stop

Tope
ajustable

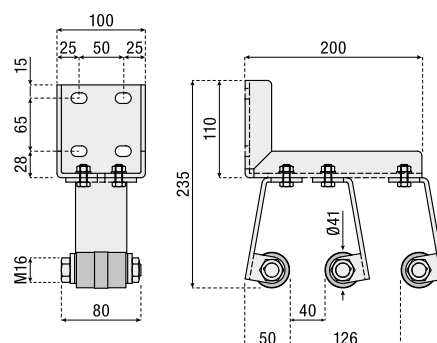

269.2

2



Kit serratura per tubo quadro

Lock kit for square post
Kit de bloqueo (cerradura) para tubo cuadrado



264.0



264.1



264.2

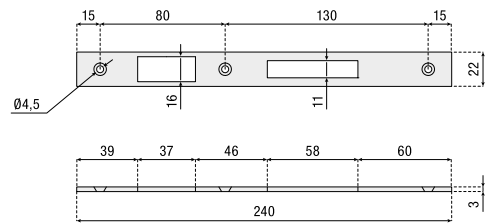
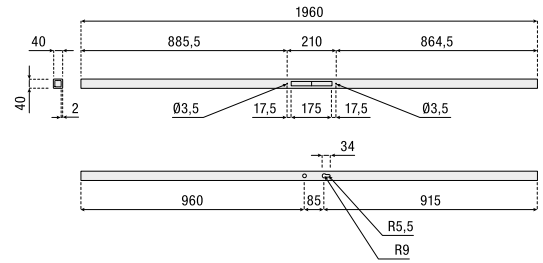
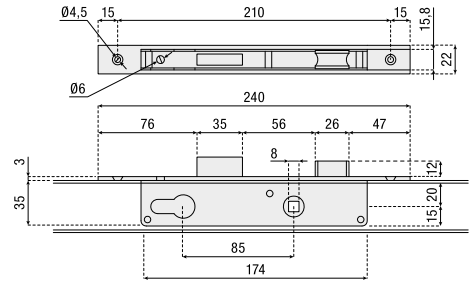

264.0	Serratura con cilindro Lock with cylinder Cerradura con cilindro	10
264.1	Tubo Tube Tubo 40 x 40 x 2 mm - l= 1960 mm	1
264.2	Controflangia nickelata Nickelated counter plate Contra brida de niquel	100



Serratura a gancio per cancelli scorrevoli

Hook lock for sliding gates
Cerradura con gancho para puertas correderas

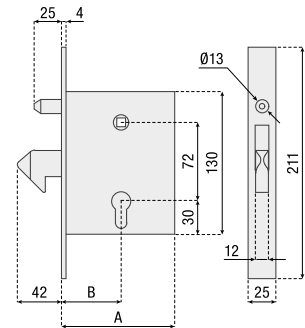

	A (mm)	B (mm)	
265.1	99	50	2
265.2	100	60	2
265.3	110	70	2



Serratura INOX a gancio per cancelli scorrevoli

Stainless steel hook lock for sliding gates
Cerradura INOX con gancho para puertas correderas

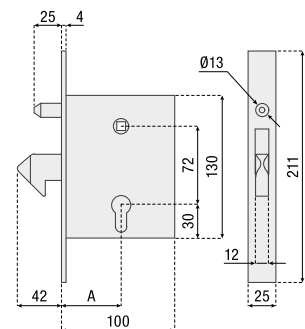

	A (mm)	
266.2	60	2
266.3	70	2



Scatola copriserratura a gancio

Hook cover-lock box
Caja cubrecerradura con gancho

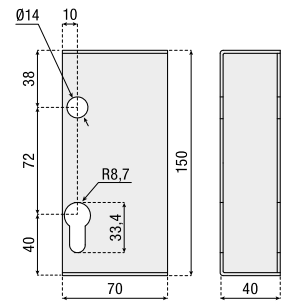

Per tutte le serrature cod. 265 e 266

For all locks cod. 256 and 266
Para todas las cerraduras cód. 265 y 266

267.0		5



Incontro per serratura a gancio

Limit stop for hook lock
Platina de contacto para cerradura con gancho

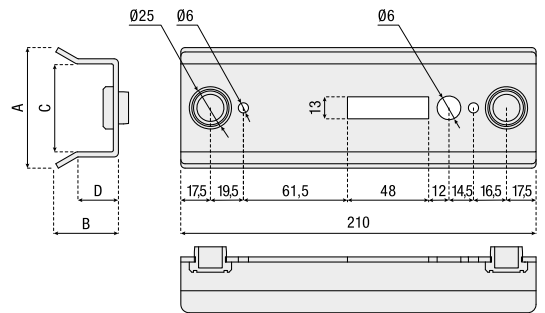

	A (mm)	B (mm)	C (mm)	D (mm)	
268.1	61	33	42	20	8
268.2	71	37	52	24	8
268.3	81	41	62	28	6



Serratura a gancio per cancelli scorrevoli

Hook lock for sliding gates
Cerradura con gancho para puertas correderas

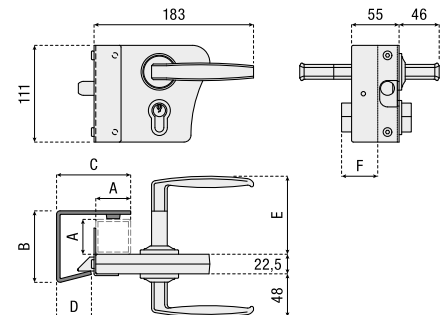

	A (mm)	B (mm)	C (mm)	D (mm)	E (mm)	F (mm)	
271.30	30	75	75	45	80	30	1
271.40	40	82	80	40	90	42	1
271.50	50	92,5	85	40	100	55	1



Maniglia con rosetta senza fori e con vite in testa

Handle on rose without keyhole and with head screw
Manilla con arandela sin orificios y con tornillo de cabeza

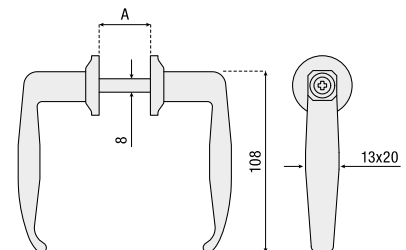

	A (mm)	
946.2	35-50	10
946.3	45-60	10
946.6	70	10



Copricolonna zincato quadrato con bordo

Galvanized square caps with flange

Cubrecolumna galvanizada cuadrada con borde

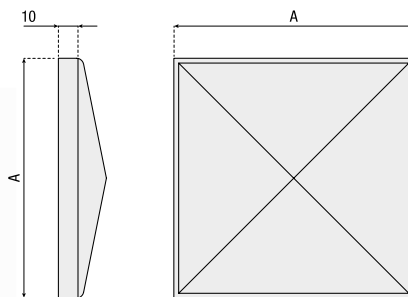

	A (mm)	
550.30	30	40
550.35	35	30
550.40	40	50
550.50	50	40
550.60	60	50
550.80	80	50
550.100	100	50
550.120	120	20
550.150	150	25
550.200	200	10



Copricolonna grezzo quadrato con bordo

Unrefined square caps with flange

Cubrecolumna de fundición cuadrada con borde

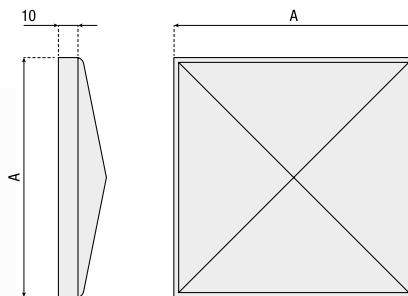

	A (mm)	
551.30	30	40
551.35	35	30
551.40	40	50
551.50	50	40
551.60	60	50
551.80	80	50
551.100	100	50
551.120	120	20
551.150	150	25
551.200	200	10



Copricolonna grezzo rettangolare con bordo

Unrefined rectangular caps with flange

Cubrecolumna de fundición rectangular con borde

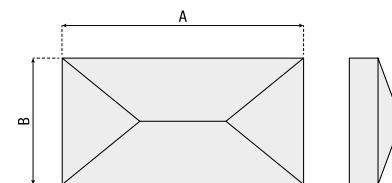

	A (mm)	B (mm)	
553.3050.0	50	30	50
553.4060.0	60	40	50
553.4080.0	80	40	50
553.50100.0	100	50	50